

ALUMINUM POWERGLIDE

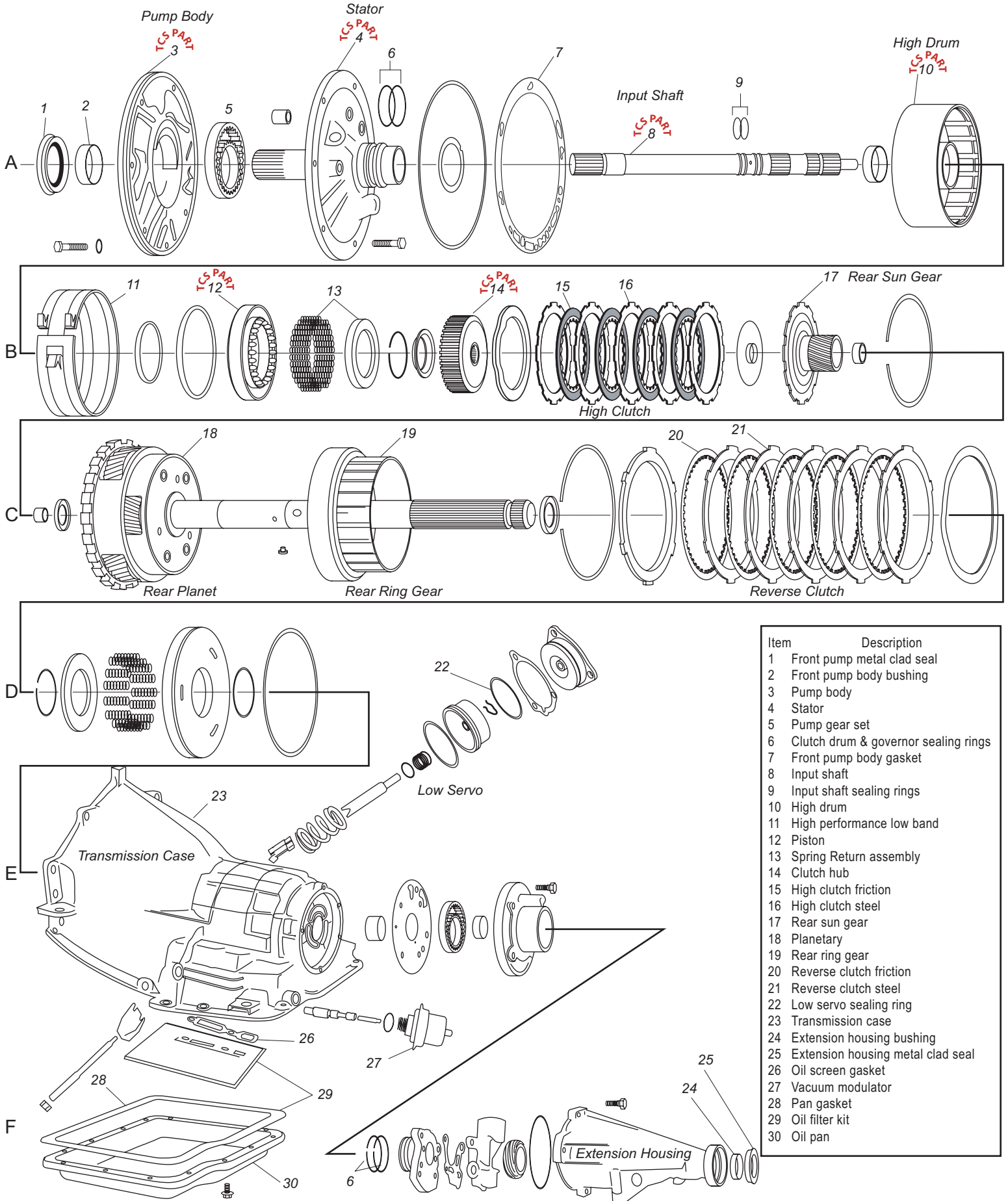

| Item | Description |
|------|--------------------------------------|
| 1 | Front pump metal clad seal |
| 2 | Front pump body bushing |
| 3 | Pump body |
| 4 | Stator |
| 5 | Pump gear set |
| 6 | Clutch drum & governor sealing rings |
| 7 | Front pump body gasket |
| 8 | Input shaft |
| 9 | Input shaft sealing rings |
| 10 | High drum |
| 11 | High performance low band |
| 12 | Piston |
| 13 | Spring Return assembly |
| 14 | Clutch hub |
| 15 | High clutch friction |
| 16 | High clutch steel |
| 17 | Rear sun gear |
| 18 | Planetary |
| 19 | Rear ring gear |
| 20 | Reverse clutch friction |
| 21 | Reverse clutch steel |
| 22 | Low servo sealing ring |
| 23 | Transmission case |
| 24 | Extension housing bushing |
| 25 | Extension housing metal clad seal |
| 26 | Oil screen gasket |
| 27 | Vacuum modulator |
| 28 | Pan gasket |
| 29 | Oil filter kit |
| 30 | Oil pan |

POWERGLIDE HIGH PERFORMANCE PRODUCTS

Powerglide Aluminum High Gear Clutch Drum

Product #743920A

- This drum is made from 7075-T6 billet aluminum and will hold up to 9 clutches.
- The extra short piston is made from 7075-T6 billet aluminum.
- Weighs 2.18 lbs. versus O.E.M. weight of 5.90 lbs.

Powerglide Steel High Gear Clutch Drum

Product #743920S

- This drum is made from 4140 HTSR steel and will hold up to 9 Alto Red Eagle clutch plates.
- This unit offers greater clutch performance.
- Available as a complete kit see part #K743920S

Powerglide Extra Short Aluminum Clutch Piston

Product #744000PS

- CNC machined from 7075-T6 billet aluminum, lighter than conventional Powerglide clutch pistons.
- Designed to be used with the TCS clutch drum and hub assembly (Part# K743920S).

Powerglide Steel Clutch Drum Kit

Product #K743920S

- 9 Alto Red Eagle clutch plates - 15% greater clutch area than the 7&8 plate clutch packs.
- New 7075-T6 billet aluminum clutch piston.
- New steel clutch hub.
- Steels, springs, and retainers.
- Can accommodate up to 1,600 horsepower engines.

Powerglide Complete High Gear Clutch Drum Kit

Product #K743920A

- NEW 2nd generation high gear aluminum clutch drum.
- Drum is CNC machined from billet 7075-T6 aluminum.
- Drum weighs 2.18 lbs. versus 5.90 lbs. on the stock drum.
- One TCS CNC machined steel clutch hub.
- One extra short billet aluminum piston.
- "Replaceable" bushing/sealing ring sleeve, made from 660 bearing bronze with lubrication channel.
- One spring retainer.
- 10 turbulator Kolene steel plates.
- Holds up to 9 Alto Red Eagle frictions .
- 24 springs.

Powerglide Large Piston Steel Drum

Product #743920SH

- 29% More Piston Apply Area! This aluminum piston delivers the most clamping force available today.
- 9 or 10 plate design.
- Dual Apply feed slots.
- 100% drop In assembly.
- Also available as a complete Kit, Part# K743920SH.

Powerglide Large Piston Steel Drum Kit

Product #K743920SH

- 29% more piston apply area, 1 - aluminum clutch piston, 10 - steels, 9 - frictions, 24 - springs, 1 - spring retainer, 1 - snap ring, 1 - large wear plate, 1 - small wear plate, 1 - clutch hub.
- Also available as drum & piston only. part# 743920SH



POWERGLIDE HIGH PERFORMANCE PRODUCTS **Powerglide Long Steel Clutch Hub for 9 Clutches****Product #748300SL**

This unit is made for engines producing up to 2,400 horsepower.

- Made from 4140 HTSR billet steel.
- Slotted to reduce rotational weight.
- When used in combination with the TCS high clutch drum piston (part#744000PS) the long steel hub will accomodate 9 Alto Red Eagle frictions for a yield of 15% more clutch area!
- Can be used with any combination of Raybestos blue plates.
- Will retrofit to stock Powerglide drums and accept up to 9 Alto Red Eagle frictions.

**Powerglide Standard Steel Clutch Hub****Product #748300S**

This unit has been manufactured to be used in engines producing up to 1,200 horsepower.

- Made from 4140 HTSR billet steel.
- Slotted to reduce rotational weight.
- It can also be used with any combination of Raybestos Blue Plates.
- Will retrofit to stock Powerglide drums and accept up to 8 Alto Red Eagle frictions.

**Powerglide Turbo 30 Spline Input Shaft****Product #749601**

- CNC precision machined from 300 Maraging steel.
- Increased shaft diameters for added strength.
- Extra large radii have been machined at all possible high fracture areas.
- Machined to enhance cooling circuit and lubrication.
- This input shaft is recommended for serious competition engines producing more than 600 horsepower.

**Powerglide Ringless Input Shaft & Stator Support Assembly****Product #K743400RS**

TCS manufactures this Input shaft using Aermet 100 high strength, fracture resistant steel.

- By deleting the ring grooves & modifying the lubrication channel and outlet ports we can attest to having the strongest input shaft on the market.
- Kit includes and must be used with the new TCS billet aluminum stator back and billet steel 4140 HTSR stator tube.
- The kit is a 100% bolt in for the O.E.M. pump as well as TCS's Powerglide Super Pump.

**Powerglide Stator Tube****Product #743400ST**

- This stator tube is made from billet 4140 HTSR steel.
- Available for ringless and ring type input shafts.

**Powerglide Pump Gear Set****Product #K11965**

- Powerglide pump gear set

**Powerglide Dual Sealing Ring Servo Piston****Product #723001S**

- Zero leakage Billet Aluminum Dual Steel Sealing Ring Servo Piston.



POWERGLIDE HIGH PERFORMANCE PRODUCTS

Powerglide Aluminum Stator Back c/w O'Rings

Product #743400SB

- Billet aluminum stator back comes with o'rings.



Powerglide Pump, High Volume (Super Pump)

Product #743400PH

- Superior transbrake operation at low RPM.
 - Billet aluminum pump body and stator back.
 - 20% lighter than the stock pump (11.5 lbs versus 14.4 lbs).
 - Positive stop bushing area - prevents the bushing from moving forward.
 - Area for staking bushing - prevents bushing spin.
 - Snap ring to prevent seal blow-out.
 - Lube reliefs on outer gear pockets provide superior lubrication.
 - Stator shaft made from billet 4140 HTSR steel - This shaft will NEVER spin out as often happens with press-in designs.
 - ALL pump bodies will interchange with stock support.
- This Super Pump is also available for the ringless PG input shaft-part# 749603 ringless Super Pump part# 743400PR.



Powerglide Pump Body & Gears

Product #743400BH

- Powerglide pump body & gears.



Powerglide Regular Volume Pump

Product #743400P

- CNC machined billet aluminum body, new stator tube - will last a lifetime.



Powerglide Race Prepped Reconditioned Stator Tube & Back

Product #R28154B

- This refurbished unit is completely rebuilt, and modified for high performance applications.
- New bushings and seals.
- Welded stator tube to prevent spin-out .
- Torrington bearing for high clutch drum support.



Powerglide Steel 1:80 Ratio Straight Cut Planetary Gear Set

Product #2540S

- Planetary gear set with all pinion gears, center gear, auxiliary gears and flange gear are housed in a steel carrier.
- This low 1:80 ratio planetary gear set is excellent for racing applications and is available in standard length and shorty applications.



Powerglide Black Anodized Servo Cover

Product #728000B

- A nice "Dress-Up" item for your Powerglide.
- Made from billet aluminum, lighter than the stock servo cover.
- Kit includes all mounting bolts and gasket.



POWERGLIDE HIGH PERFORMANCE PRODUCTS **Powerglide Output Shaft Support & Bearing****Product #720005**

TCS's output shaft support helps to eliminate unwanted weight and reduces rotational friction by utilizing lightweight billet aluminum and, replacing the traditional bushing with a needle bearing.

- The TCS output shaft support has been designed for race applications
- This output shaft support is 53% lighter than the stock unit - 1.1 lb. versus 2.35 lbs.

**Powerglide Shorty Housing & Bearing****Product #746401**

- CNC machined from billet 7075-T6 aluminum.
- This unit utilizes a low drag needle bearing and, comes complete with all bolts, washers and gasket.
- A snap ring seal and bearing have been added for safety.
- Will Retro-Fit to ALL Powerglide transmission cases - Reid, AT1 and JW.

**Powerglide Band****Product #625101**

High energy lining for the Powerglide.

**Powerglide Extra Wide Racing Band****Product #625102****Powerglide Boost Valve Assembly****Product #28999-01K**

- High performance design .489 diameter at the small spool.
- Provides excellent hydraulic sealing capabilities.
- Maximum pressure in extreme application.

**Powerglide Reid Racing 1 Piece Superglide Transmission Case****Product #PG-1000L**

- Reid Racing 1- Piece Superglide Transmission Case.
- No external shield required because the safety liner insert makes it SFI 4.1 Certified.
- The Bellhousing is SFI 30.1 Certified.

**Powerglide Reid Racing Extension Housing****Product #PGH-1**

- Sold separately from the Reid Case, this extension housing is cast from aluminum.

