

TH400 (3L80), 375, 3L80-HD(475) - RWD 3 SPEED

Toll Free: 800-960-1177

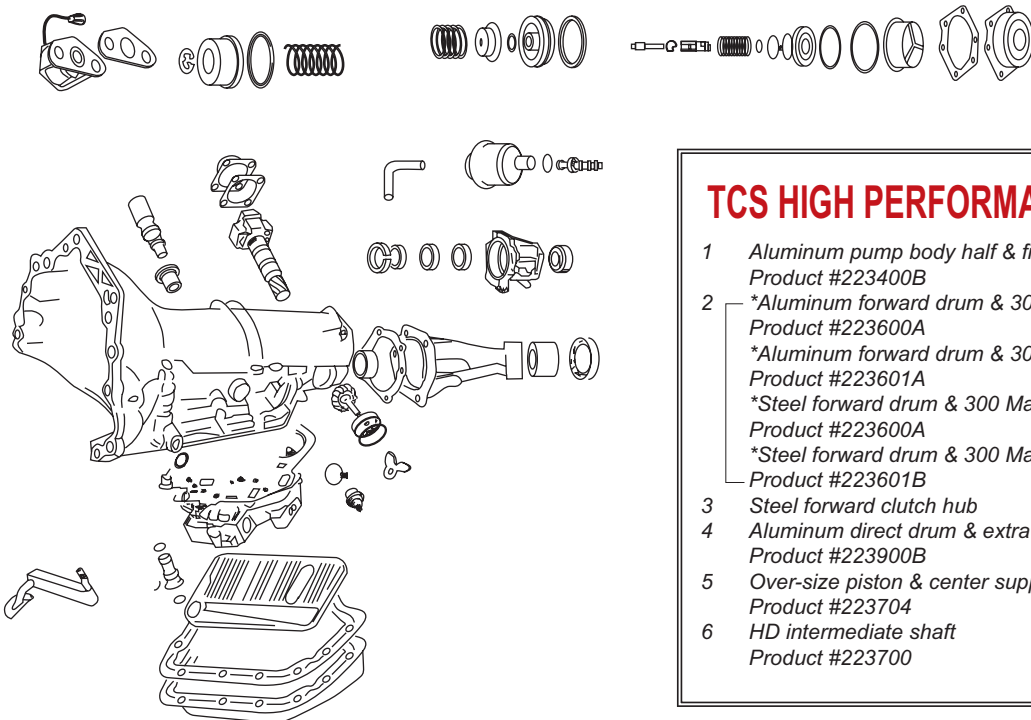
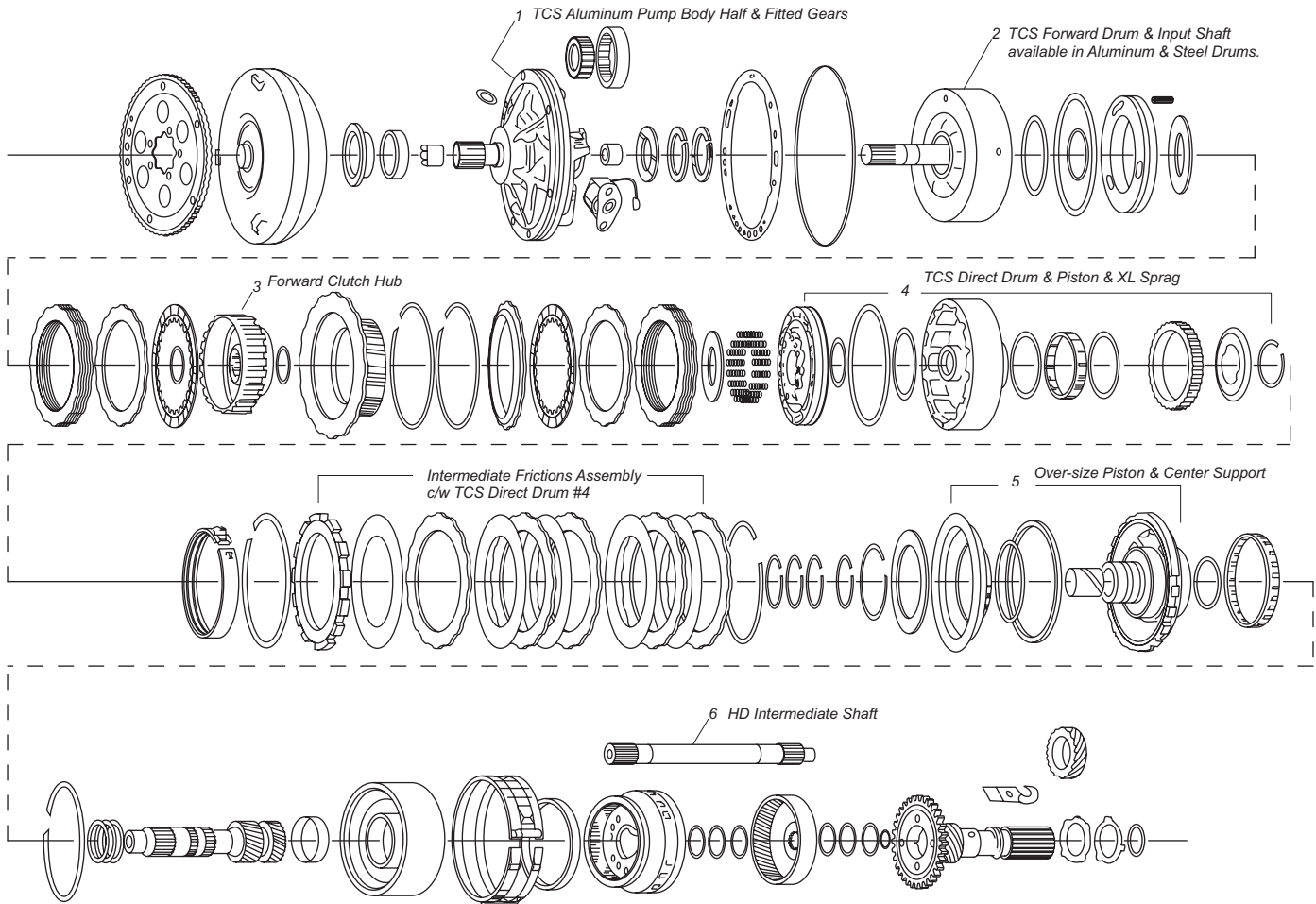

TCS HIGH PERFORMANCE PRODUCTS

- 1 Aluminum pump body half & fitted gears
Product #223400B
- 2 *Aluminum forward drum & 300 Maraging input shaft
Product #223600A
*Aluminum forward drum & 300 Maraging input shaft w/modified lube circuit
Product #223601A
*Steel forward drum & 300 Maraging input shaft
Product #223600A
*Steel forward drum & 300 Maraging input shaft w/modified lube circuit
Product #223601B
- 3 Steel forward clutch hub
- 4 Aluminum direct drum & extra large sprag
Product #223900B
- 5 Over-size piston & center support
Product #223704
- 6 HD intermediate shaft
Product #223700

TH400 (3L80), 375, 3L80-HD(475) - RWD 3 SPEED

Toll Free: 800-960-1177

TCS HIGH PERFORMANCE PRODUCTS

TH400 Aluminum Pump Body Half & Fitted Gears

Product #223400B

For high horsepower applications e.g. supercharged, turbocharged, nitrous or, mega cubic inch engines.

- Oversized center support piston and bore by .250" (stock piston is 5.617" - TCS piston is 5.877" diameter), the increased diameter applies more clamping force on the second gear clutch-pack.



TH400 Aluminum Forward Drum & 300 Maraging Input Shaft

Product #223600A

TH400 Aluminum Forward Drum & 300 Maraging Input Shaft w/Modified Lube Circuit

Product #223601A

TH400 Steel Forward Drum & 300 Maraging Input Shaft

Product #223600A

TH400 Steel Forward Drum & 300 Maraging Input Shaft w/Modified Lube Circuit

Product #223601B



TH400 Steel Forward Clutch Hub

Product #228300B

- Made from 4140 HTSR billet steel to eliminate spline failures in high horsepower applications.
- Two Torrington thrust bearings replace the conventional thrust washers.
- Designed to be used in applications over 600 Horsepower.



TH400 Aluminum Direct Drum & Extra Large Sprag

Product #223900B

Ideal for ProStreet, ProMods and Top Sportsman.

- Drum is made from 7075 T6 billet aluminum, weighs 45% less than the O.E.M. drum.
- Billet aluminum piston.
- Holds up to 6 frictions.
- 1/4" locking dowels have been inserted to stop inner race movement.
- Steel sleeve for sealing ring.
- 3 Sure sealing rings.
- 5 Intermediate frictions, steels and pressure plate.
- Drum and Sprag weigh 6.13 lbs.
- X-Large 36 element sprag.



TH400 Over-Size Piston & Center Support

Product #223704

For high horsepower applications ie; supercharged, turbocharged, nitrous or, mega cubic inch engines.

- Piston and bore diameter increased by 1/4" for more clamping force on the second gear clutch-pack.



TH400 HD Intermediate Shaft

Product #223700

- This TH400 Intermediate shaft is a "bolt-in" product made from 300 Maraging Steel and has been designed for High Horsepower and Off-Road use.



TH400 Forward Drum with Input Shaft

Product #223600

Made for Drag Racers, Mud Buggers and Extreme Off-Roaders.

- Refurbished OEM drum with a TCS input shaft made from 300 Maraging steel. Spline area increased by 56%
- 100% bolt-in product

